

ECC-550P1 B&W PINHOLE CAMERA

ECC-850P1 COLOR PINHOLE CAMERA

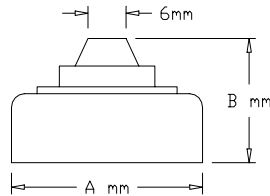

Dimension	550P1	850P1
A	25	34
B	19	18

~ Description ~

ECC series Pinhole are high-performance cameras specially designed for indoor, low profile surveillance. The casing is made of Aluminum with non-reflective epoxy powder coating, providing a tough, light weight and good heat conductor for the camera.

~ Features ~

- 1/3" Sony CCD
- Compact size & Light Weight
- Wall & Ceiling Mounting Bracket Included
- Easy installation
- Reverse polarity protection
- Wide Voltage Range 9-14VDC
- 3.7mm Wide Angle Lens
- B/W : ECC- 550P1
- Color : ECC-850P1

~ Specifications ~

Model	ECC-550P1	
Image Sensor	1/3" Sony CCD	1/3" Sony CCD
Effective Pixels	512(H) x 582(V)	
Synchronization	Internal	
Lens	3.7mm (Cone Type)	
Horizontal Resolution	420 TV Lines	420 TV Lines
Minimum Illumination	0.1 Lux	1.0 Lux
S/N Ratio	48dB	
Electronic Iris	1/60 to 1/100,000s	
Video Output	1Vp-p Video Composite	
Power Consumption	12VDC, 100mA Max.	12VDC, 50mA Max.
Operating Temperature	0° to +50° C (non-condensing)	
Weight	40g	48g